

# MANUAL ROLLING COVER INSTALLATION INSTRUCTION

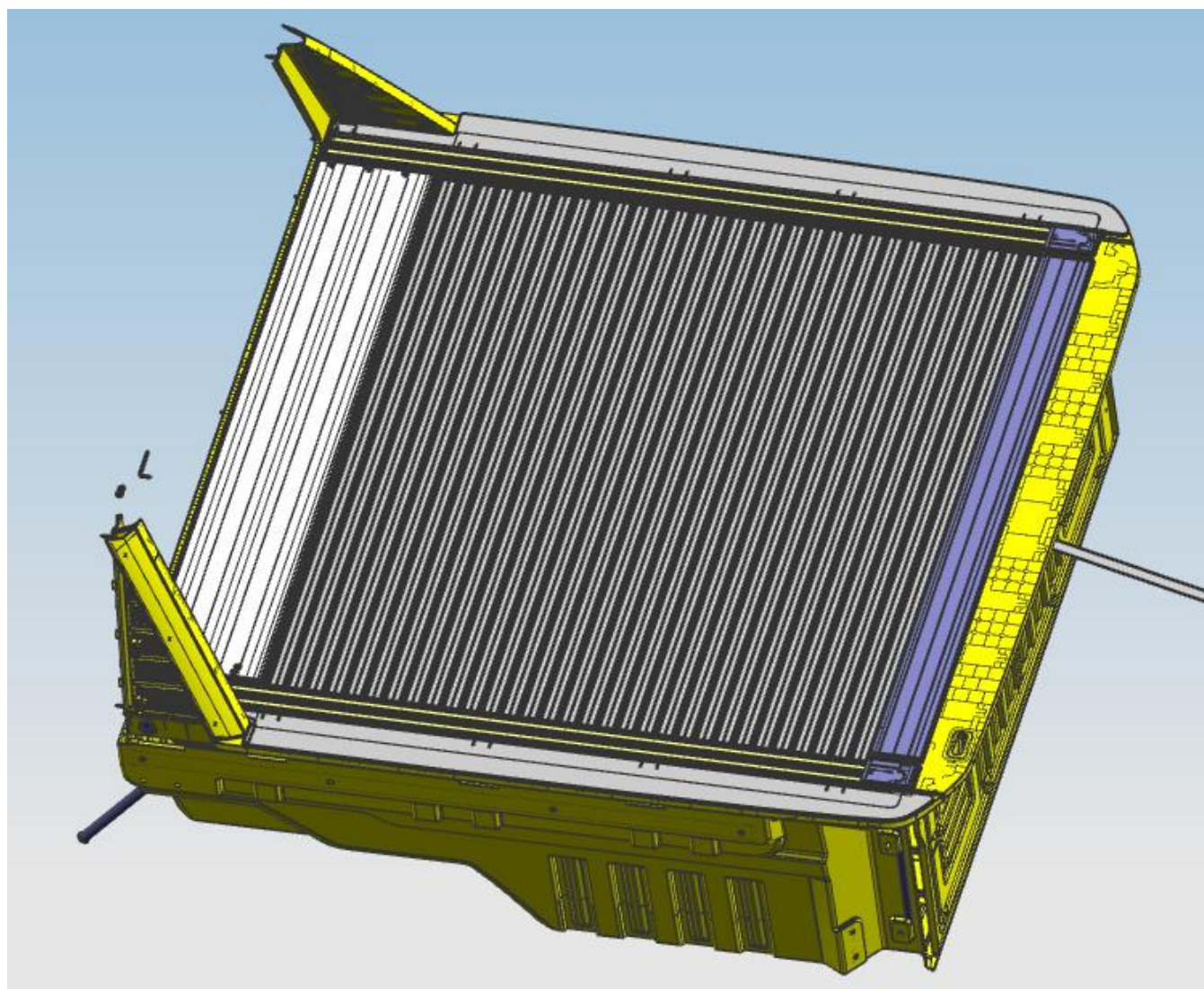

## Before installing

Please read the instructions thoroughly for installation, which will also help you avoid scratches or other potential damage to your car.

Please periodically check and tighten all hardware and clean the product to maintain its appearance.

## Parts List



Roller

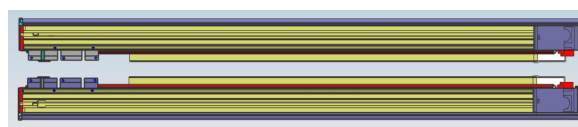

Side rail (left/right)

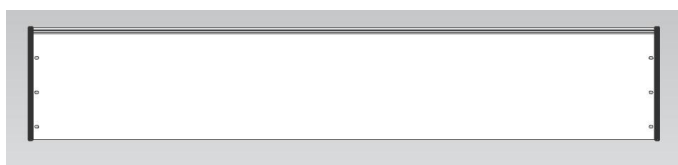

Aluminum cover plate  
and small cover plate

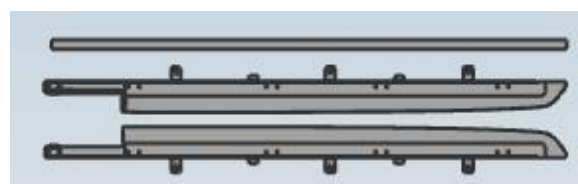

Foam and iron groove  
bracket (left/right)

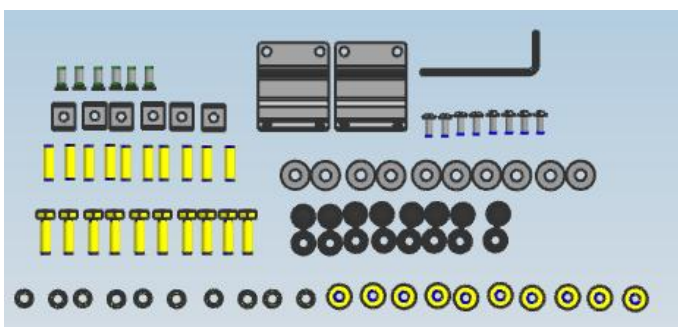

Accessories bag



Drainage pipes &  
jubilee clips

## Installation Steps

### 1. Assemble the roller cover as following

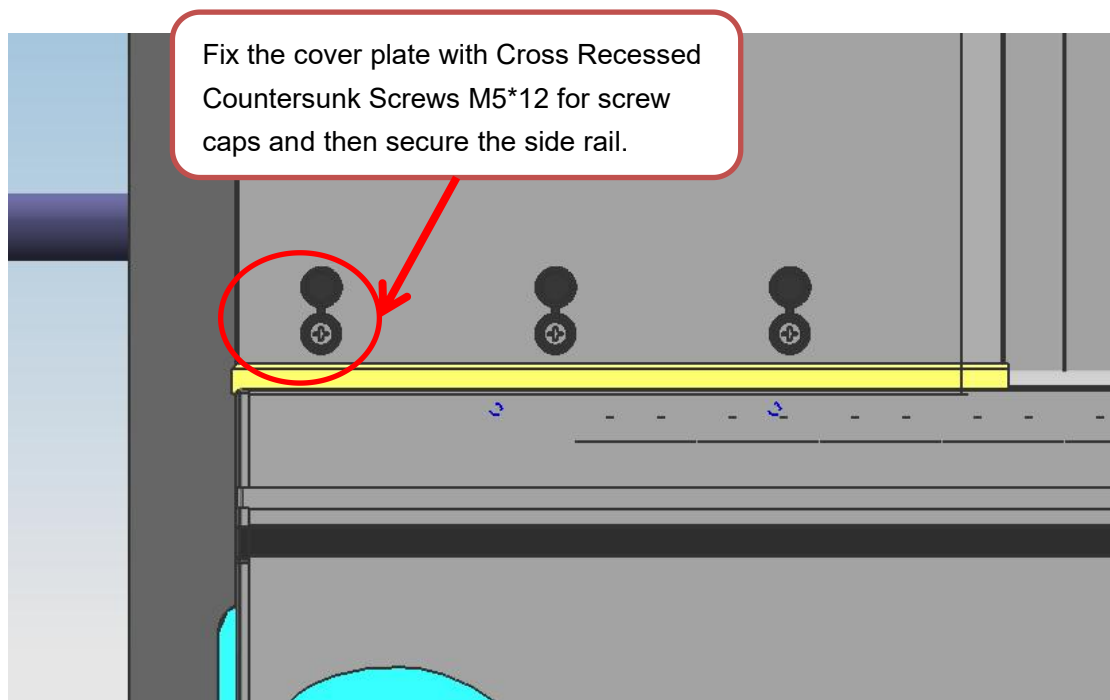
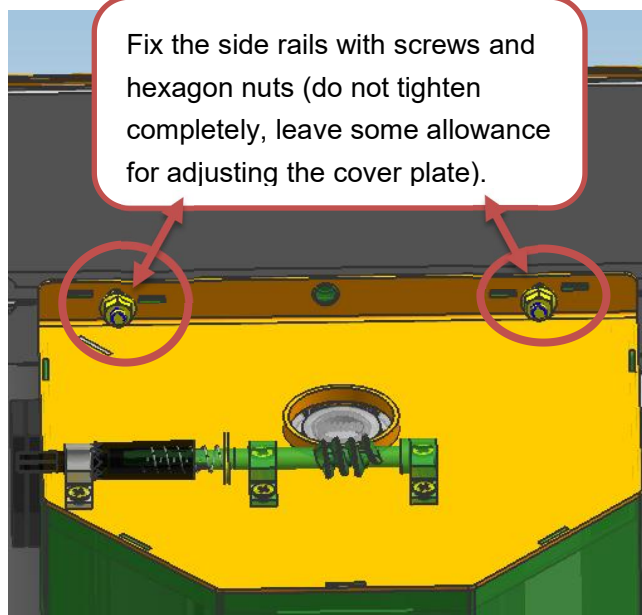
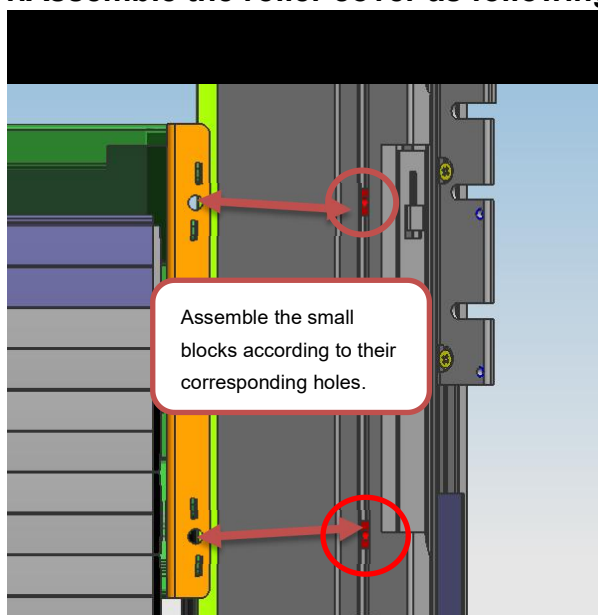

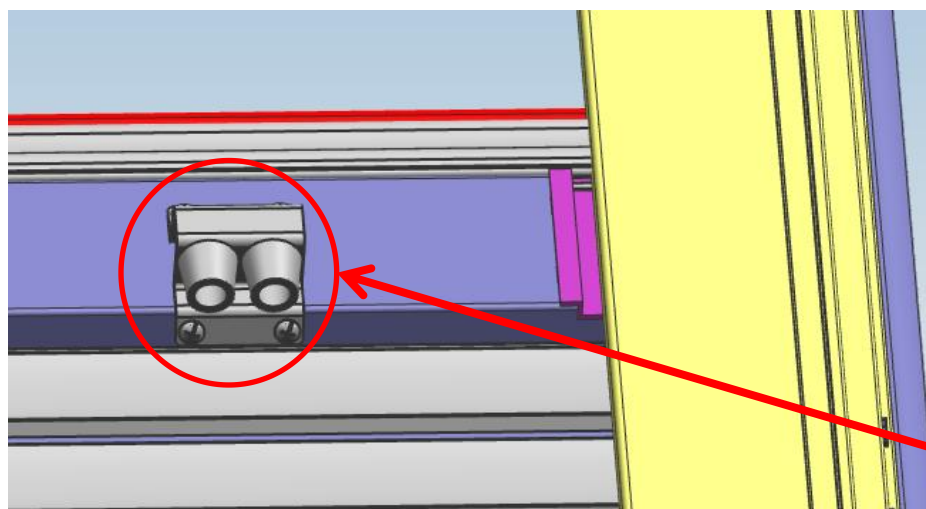
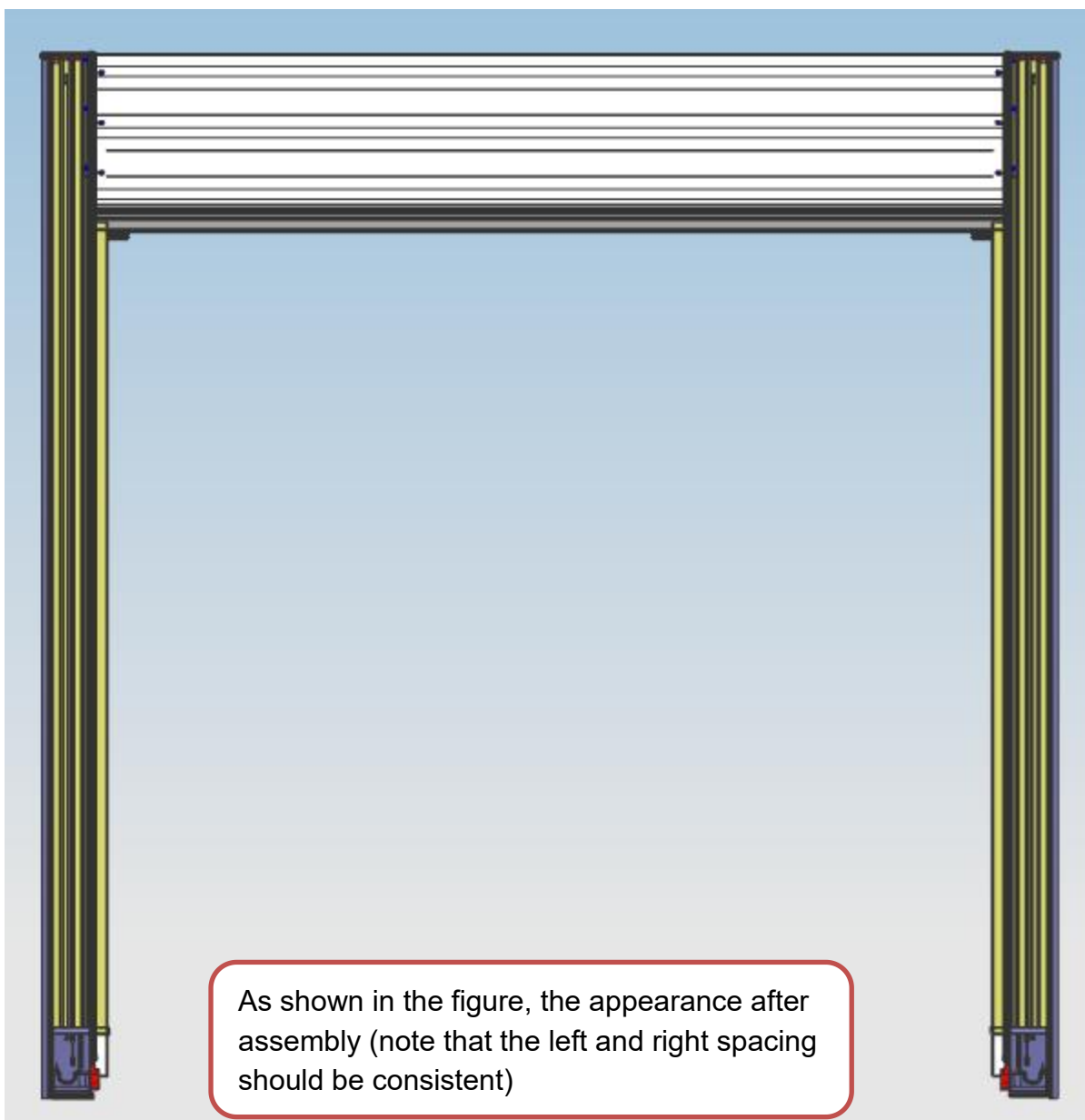

After assembling the roller shutter, pull out a portion of the shutter to install the roller shutter protective plate using cross-recessed pan head screws M4\*10.

## 2. Install the loading bracket.

Step 1: Stick the foam firmly along the edge of the carriage, as shown in the figure below.

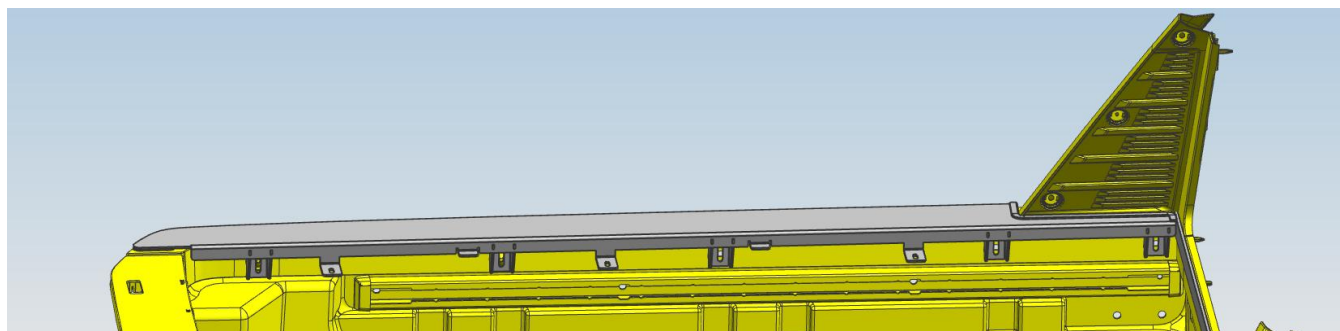
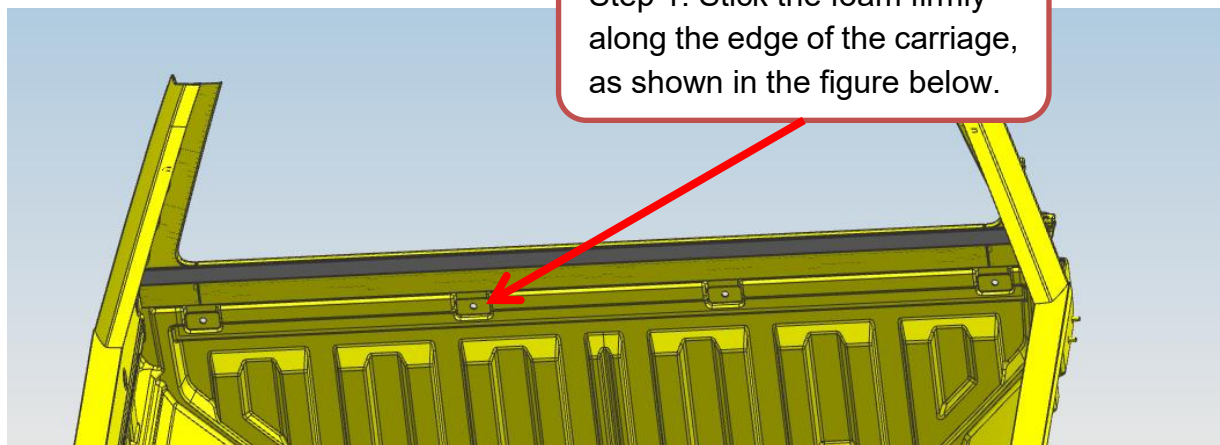

Step 2: Place the left and right iron channel frames on the car gang, align them with the holes on the car gang, and note that the channel frames should be tightly attached to the original roll bar.

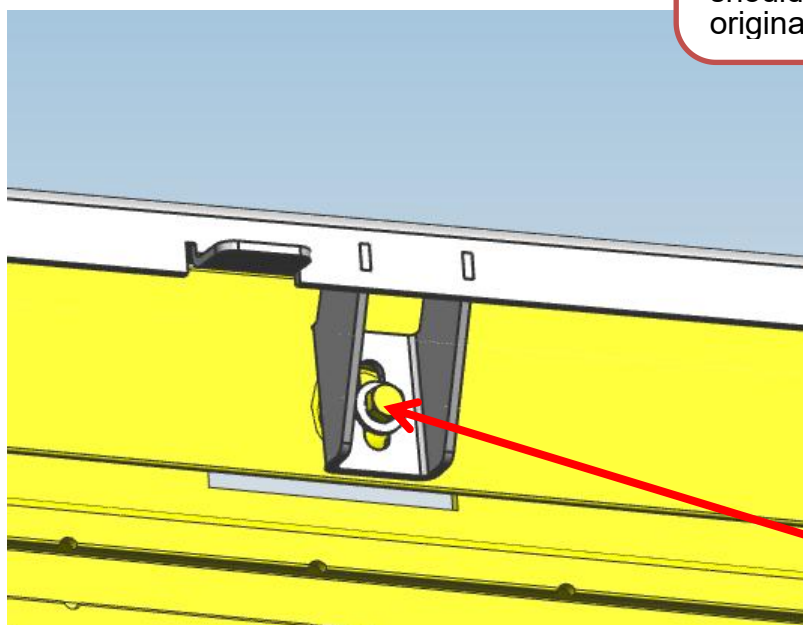

Use M6\*20 hexagon bolts with washers and spring washers to lock tightly (12 positions in total for the left and right iron channel frames).

3. Place the assembled manual roller shutter close to the inside of the carriage, measure the front and back spacing of the left and right side rail with tape measure to ensure that the roller cover is placed in the middle of the carriage, and the spacing is required to be consistent.

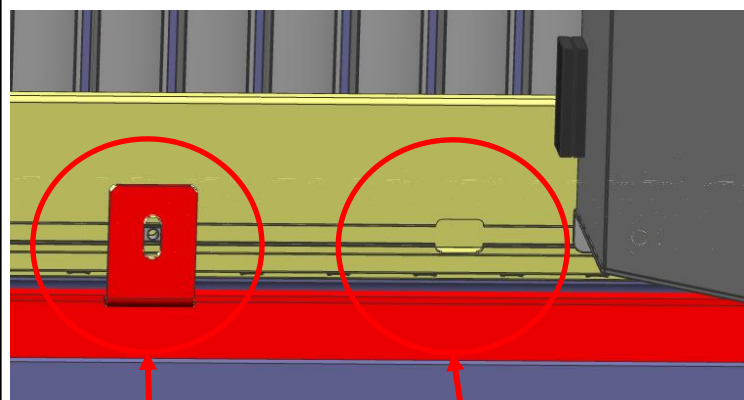

Move the small blocks to the corresponding positions.

Place the small blocks from this hole

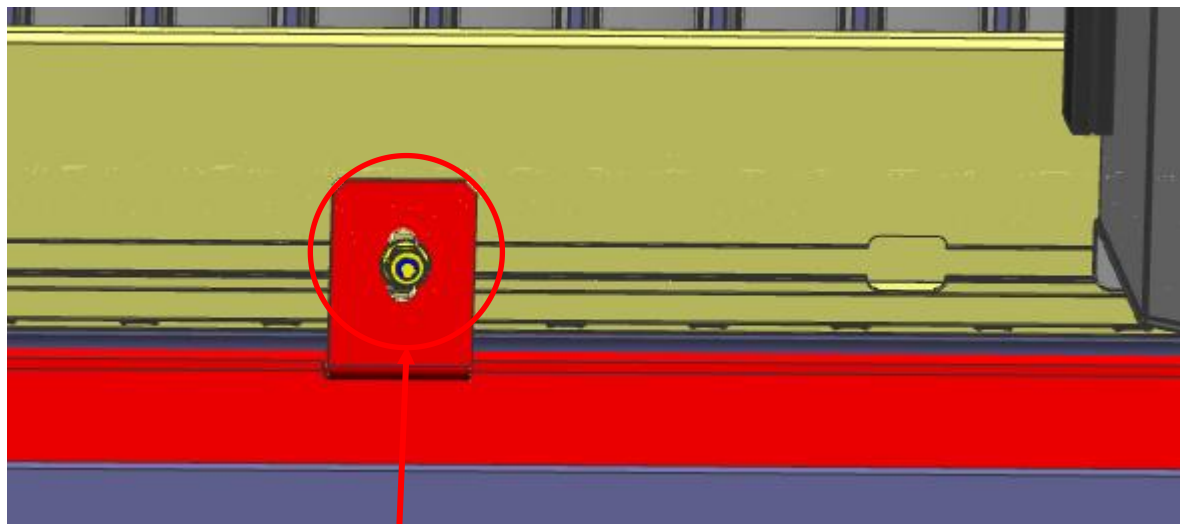

Fix here with a screw rod and a nut.

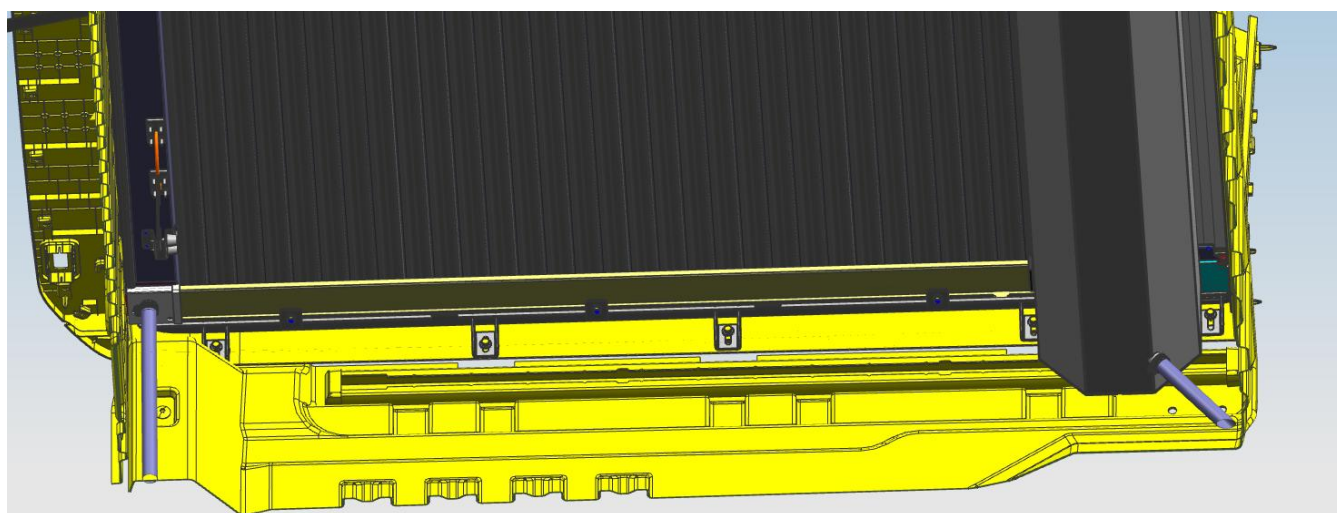

The left and right installations are the same.

#### 4. Water pipe layout, lead to the outside of the vehicle.

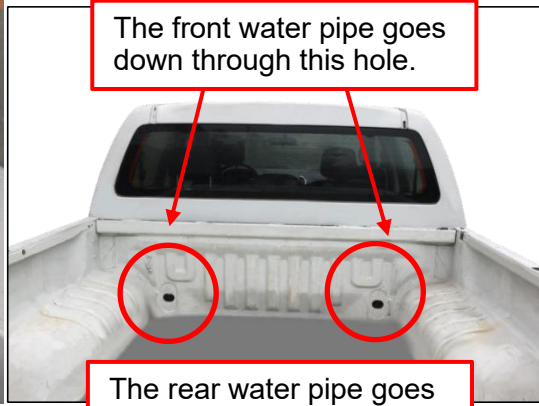

Adjust the force at this position: clockwise for increasing force, counterclockwise for decreasing force.

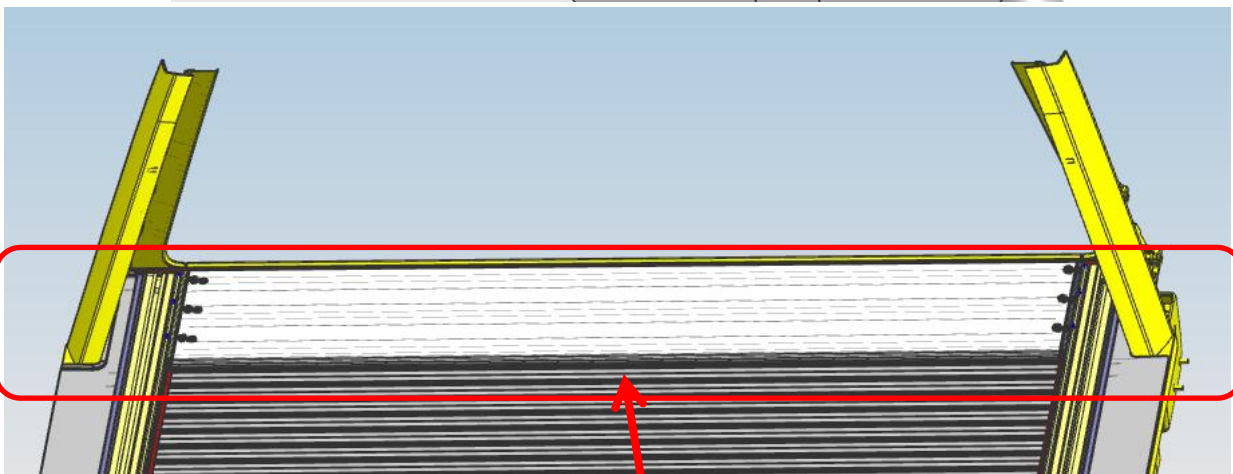
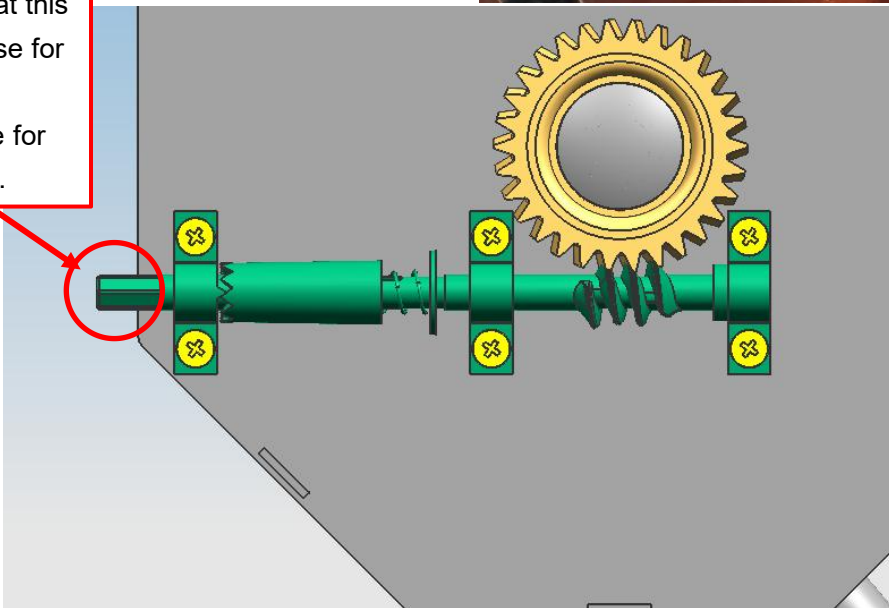

The edges of the framed area need to be coated with a layer of waterproof glue.

5. Install the bracket on the tail gate.

